

# INSTALLATION INSTRUCTIONS

DL-PS-XX/24-JB-OD-S



## **IMPORTANT SAFETY INSTRUCTIONS**

Please read carefully before using product. Protect yourself and others by observing all safety information, warnings and cautions. Failure to comply with instructions could result in personal injury and/or damage to product or property. Please retain instruction sheet for future reference.

This driver is to be installed in accordance with Article 450 of the National Electric Code. The driver must be installed in a well-ventilated area free from explosive gases and vapors. Proper operation requires for free flow of air. As this driver is hardwired it should only be installed by a qualified electrician.

## **PRECAUTIONS BEFORE INSTALLING**

Check the label and ensure the driver has the proper input voltage, output voltage and wattage for the job. Check the wire markings to ensure they match the wiring diagram on this installation guide. Ensure that the load wattage does not exceed the maximum rated wattage. Ensure **NOT** to reverse the polarity on the primary side of the driver as it will damage the product.

## **MOUNTING**

1) Select a suitable location capable of supporting the weight of the driver.

MODEL NUMBER	NET WEIGHT
DL-PS-30/24-JB-OD-S	0.95kg (2.1lb)
DL-PS-60/24-JB-OD-S	1.1kg (2.4lb)
DL-PS-96/24-JB-OD-S	1.3kg (2.9lb)

NOTE: The driver can be mounted vertically or horizontally. Keep a minimum clearance of 2" in all directions around the driver to allow for adequate air circulation.

2) Use the screwholes in the driver case to mount the driver.

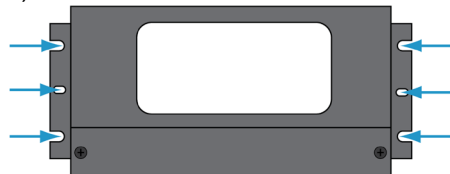

## **WIRING**

1) Remove the two screws from the top of the driver enclosure and pull off the cover plate to get to the wiring compartment.

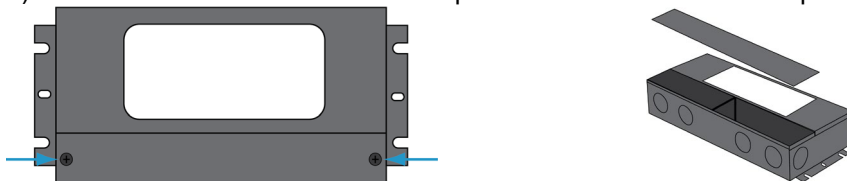

2) Input connections: With power turned off, connect the AC power from the electrical panel into the primary side of the driver. The Black wire is Hot, White wire is Neutral and Green wire is Ground. The driver case **MUST** be grounded in accordance with the National Electric Code.

3) Output connections: Connect the 24VDC load to the secondary side of the driver. The Red wire is Positive and the Black wire is Negative.

4) Once wiring is completed according to the wiring diagram on page 2, replace the cover plate. Secure by tightening the 2 screws.

# INSTALLATION INSTRUCTIONS

DL-PS-XX/24-JB-OD-S



NOTE: For all wire connections use only UL listed wire nuts and connectors of suitable size and type.

NOTE: UL Listed conduit fittings should be used. Any unused conduit opening on the driver must be covered with a UL listed conduit cap.

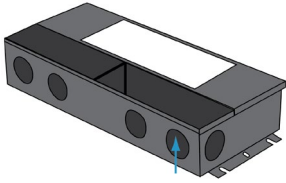

## WIRING DIAGRAMS

